



### Level 6/5/2-12 Foveaux Street Surry Hills NSW

2 - 12 Foveaux Street is a converted warehouse style office building located at the corner of Mary Street close to Central Station. The building offers on - site building management and excellent proximity to public transport, cafes, bars and eateries

- \* Approx. 158m2
- \* One partition room and open area
- \* Asking rent \$9,400 per month + GST  
Garbage Fee: \$170 per month + GST
- \* Extra high ceilings
- \* Internal kitchen
- \* Natural light
- \* Polished timber floor
- \* A minute's walk from Central station

<b>Type</b>	: Offices
<b>Price</b>	: \$9,400 plus GST pm
<b>Building Size</b>	: 158 sqm
<b>View</b>	: <a href="https://www.drakeproperty.com/lease/nsw/eastern-suburbs/surry-hills/commercial/offices/8172562">https://www.drakeproperty.com/lease/nsw/eastern-suburbs/surry-hills/commercial/offices/8172562</a>

[For full version visit the website](https://www.drakeproperty.com)

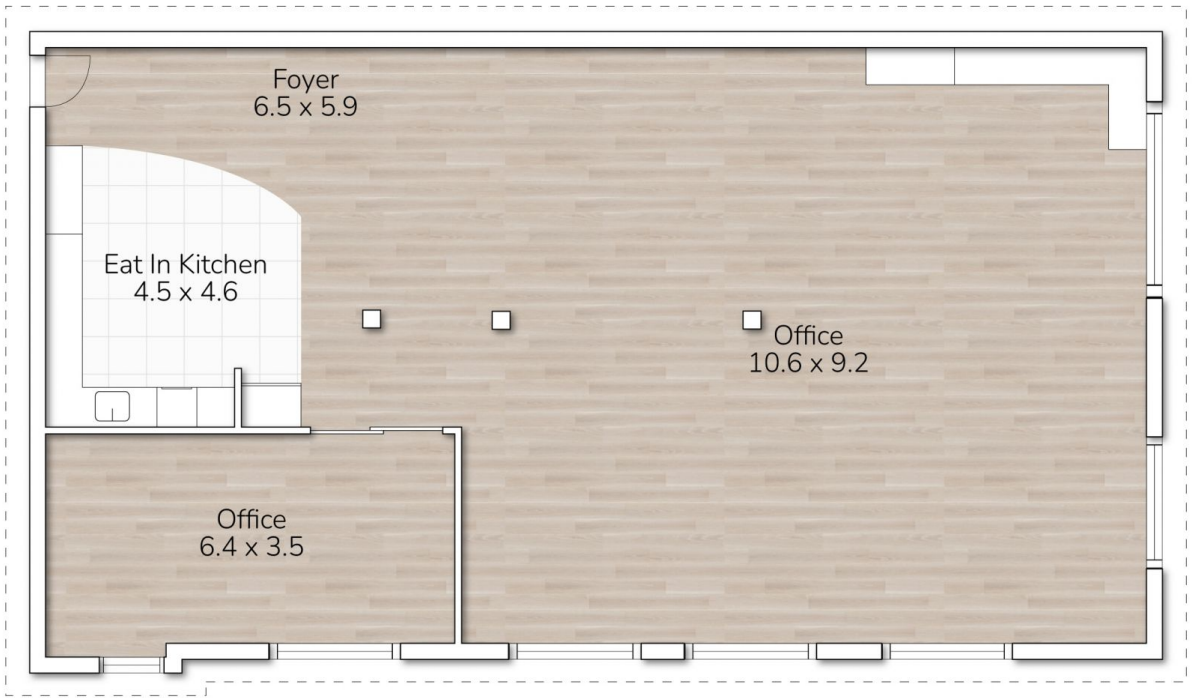

5/6-2 FOVEAUX STREET SUITE, SURRY HILLS



Total 158m<sup>2</sup>

This floor plan is for marketing purposes only. Dimensions and layout are approximate. Mountfort Media gives no guarantee or warranty over the accuracy of this plan.