

Level 5/501/265 Castlereagh Street Sydney NSW

- * Approx. 109m²
- * Five fully glassed partitioning rooms including a dry kitchen
- * Reception area
- * Directly opposite Downing Centre Law Courts
- * Close to Museum Station, Town Hall Station, World Square, Hyde Park etc

- | | |
|----------------------|---|
| Type | : Offices |
| Price | : Asking \$700 plus GST per sqm pa |
| Building Size | : 109 sqm |
| View | : https://www.drakeproperty.com/lease/nsw/sydney-city/sydney/commercial/offices/8140435 |

265 Castlereagh Street was substantially refurbished in 2010, with new electrical, air conditioning, ceilings and lighting. The upper 12 floors are serviced by 3 lifts.

Please ring David on 0492 929 791 for detailed information or inspections.

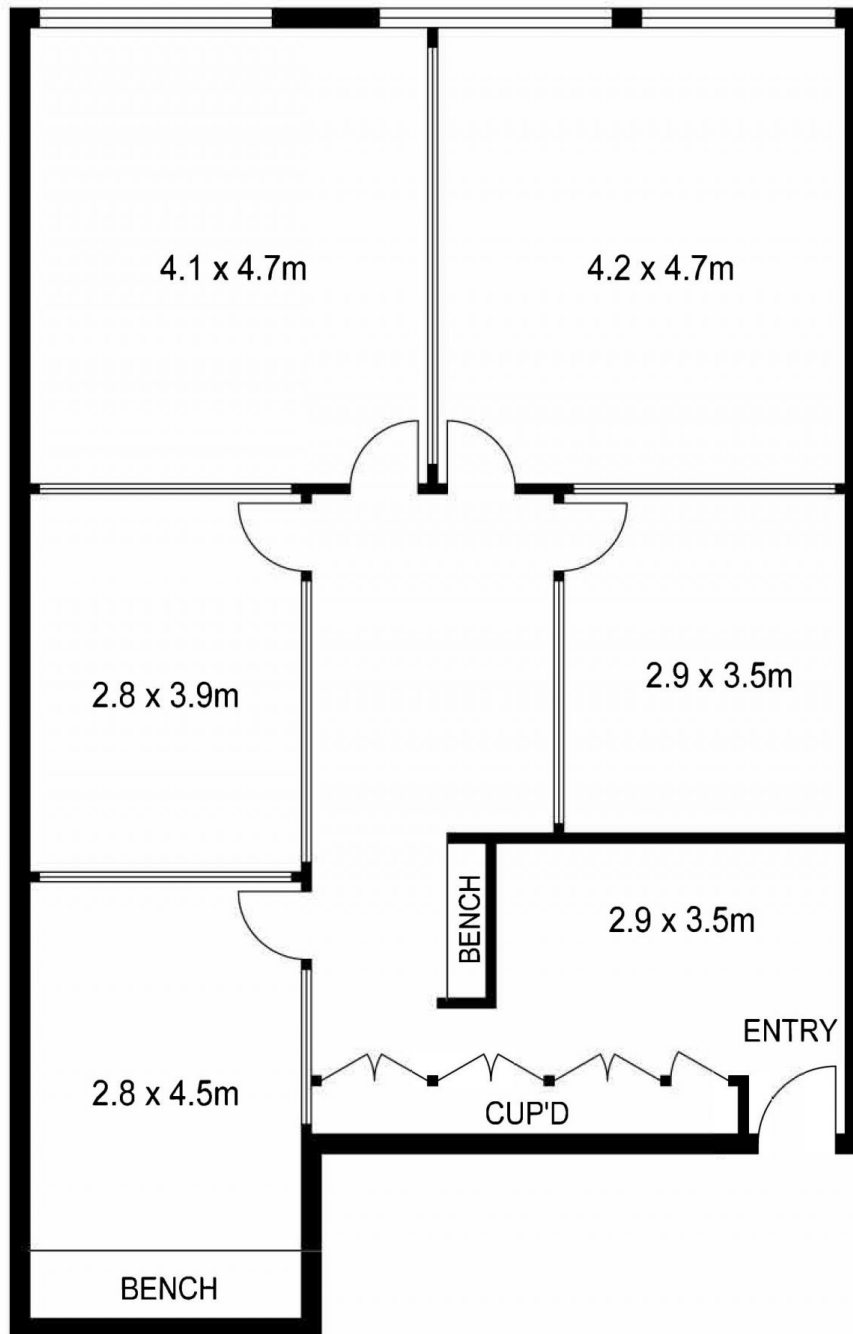

INT: 109 m²

Scale in metres. Indicative only. Dimensions are approximate. All information contained herein is gathered from sources we believe to be reliable. However we cannot guarantee its accuracy and interested persons should rely on their own enquiries.



501 / 265 Castlereagh Street, Sydney