



Level 5/457/311 Castlereagh Street Sydney NSW

- * Approx. 87m2
- * 18sqm lock up garage on the same level
- * 3 partitioned offices, reception area and open space
- * Individual air conditioning
- * Direct lift exposure
- * 2 lifts newly installed
- * Kitchen with water supply
- * Building amenities include indoor swimming pool, heated spa/sauna, table tennis, gym

Type : Offices
Price : Contact Agent
Building Size : 87 sqm
View : <https://www.drakeproperty.com/sale/nsw/sydney-city/sydney/commercial/offices/8086554>

Campbell Tower, 311 Castlereagh Street, is located on the western side of Castlereagh Street on the corner of Castlereagh Street and Campbell Streets. It is well serviced by Museum and Central train stations and also Museum bus

[For full version visit the website](https://www.drakeproperty.com)



LEVEL 5

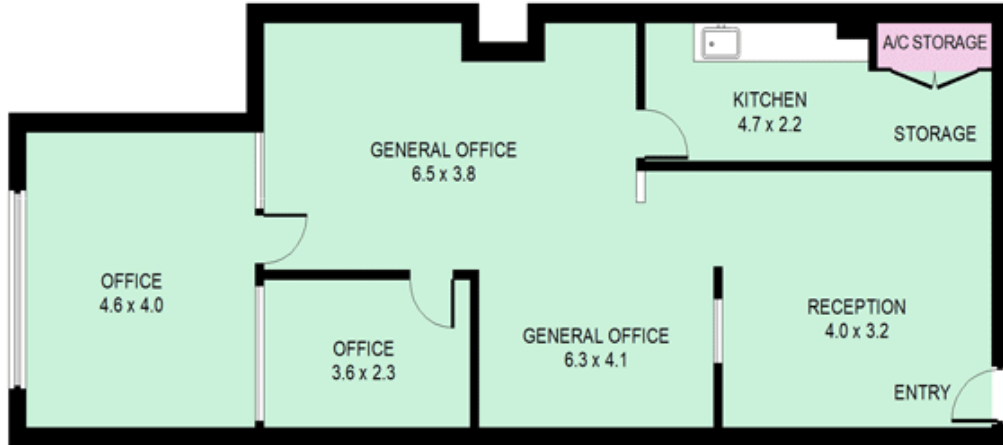

LEVEL 5

Suite 457, 311 Castlereagh Street, Sydney



This information is not to be relied upon.
It is strictly for marketing & illustration purposes only.
All measurements are approximate. Not to scale.
No liability accepted.
You must rely on your own inquiries and seek advice from your solicitor.(ID 509625)