

Level 5/504/265 Castlereagh Street Sydney NSW

The property is located directly opposite the Downing Centre Law Courts, close to World Square and Chinatown.

265 Castlereagh Street was substantially refurbished in 2010, with new electrical, air conditioning, ceilings and lighting. The upper 12 floors are serviced by 3 lifts. At this time, the majority of the upper floors were subdivided into four suites per floor.

Suite 504 is located on the north west side of the building. A quality fit out has been undertaken to suit a small solicitor's office. The office comprises a reception, client waiting area, a meeting room, two solicitor offices and a common area providing work space for 5-78 assistant staff with good storage facilities.

Building Size : 81 sqm
Land Size : 81 sqm
View : <https://www.drakeproperty.com/lease/nsw/sydney-city/sydney/commercial/offices/5723825>



Nicholas Drake
02 9283 6280

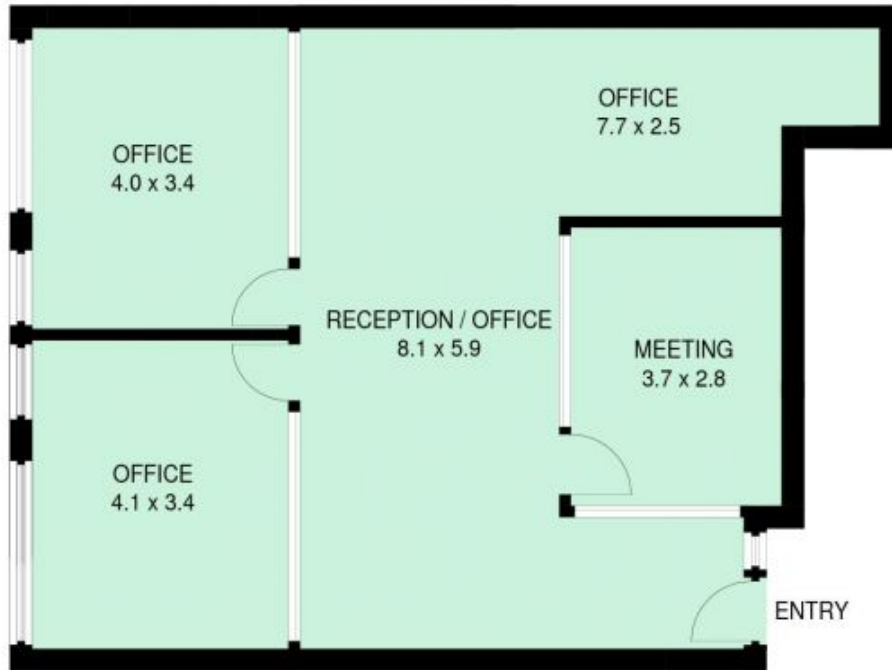

LEVEL FIVE

Suite 504, 265 Castlereagh Street, Sydney

This information is not to be relied upon.

It is strictly for marketing & illustration purposes only.

All measurements are approximate. Not to scale.

No liability accepted.

You must rely on your own inquiries and seek advice from your solicitor. (ID366084)

