



### Level Ground/25 Dixon Street Haymarket NSW

Harbour Plaza, 25 Dixon Street Haymarket is a Pagoda Style commercial building in the heart of Chinatown, home to an exciting mix of restaurants, food halls, snack bars and gift shops, a vibrant entertainment precinct with clubs, theaters and cinemas operating to late night.

**Building Size** : 353 sqm  
**View** : <https://www.drakeproperty.com/lease/nsw/sydney-city/haymarket/commercial/retail/5723792>

This dual level shop is situated at the building entrance with a perfect street exposure. It also features:

- \* Approximate 353m<sup>2</sup> in total with 48m<sup>2</sup> outside seating
- \* Glass walls on ground floor
- \* Provisioned for grease trap and kitchen exhaust
- \* Internal staircase
- \* Suitable for general retail or restaurants

Please ring Samuel on 0408 422 771 for inspection.

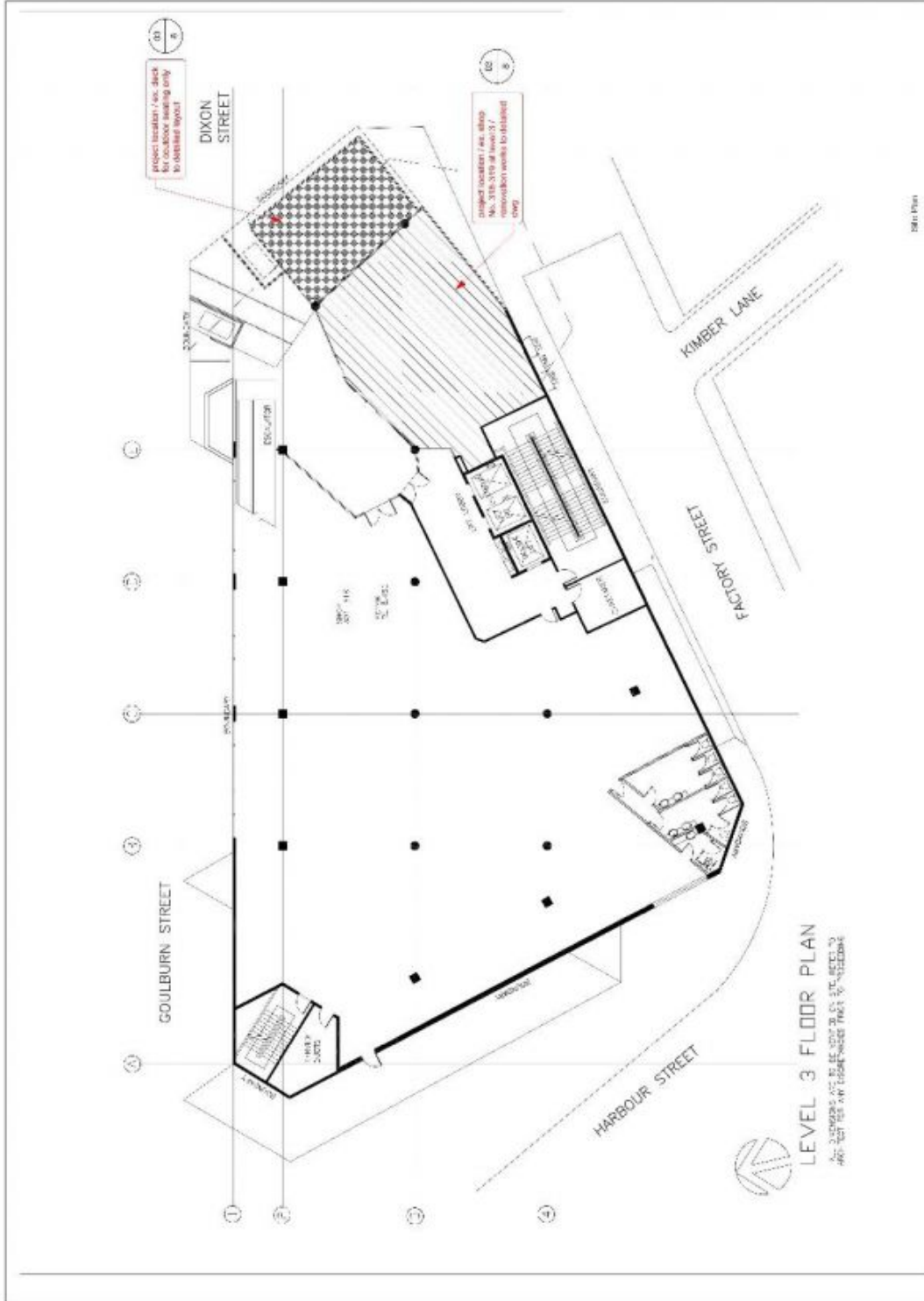

Site Plan

ORIGINAL LEVEL 3 SITE PLAN 1  
SCALE 1:150 101

 No. 10/10 Design Pty Ltd 1/1022 Jervis St, Sydney NSW 2000 T: 0025 6287 E: info@myawidesign.com.au	client: <b>HARBOUR PLAZA</b>	Drawn by: <b>JACK ZHU</b>	Original Title: <b>ORIGINAL LEVEL 3 SITE PLAN</b>	
	project: <b>LEVEL 3 - LEVEL 4 DA</b>	Date of approval: <b>06.04.2016</b>	Drawing Status: <b>1:150/DA3</b>	Drawing Number: <b>101</b>
notes: • All works to be undertaken with the Building and Fire Safety Regulations and local authority requirements. • Contractor to verify MW of any structure, and the actual construction of the roof for distribution prior to construction. • BFF design to improve all structures detailed above regarding structure to construction. • Contractor to liaise with Electrical contractors to ensure all power data, connections to equipment are accessible. • All drawings to be sealed on site - as indicated.	issue: <b>A</b>	FOR DA	issue: <b>JZ</b>	issue: <b>06.04.2016</b>